

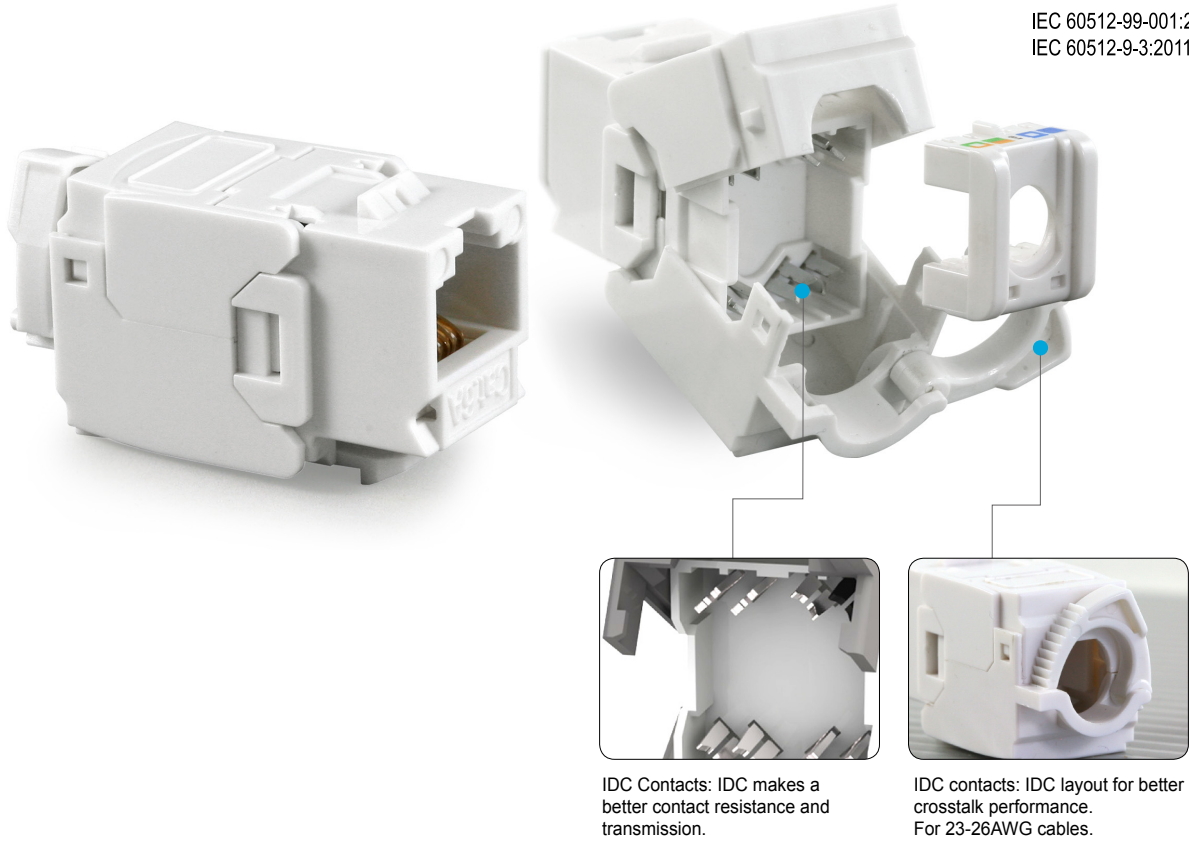

# Class E<sub>A</sub> / Cat.6A UTP Toolless Module (Auto press fit) TB96P6AU



IEC 60512-99-001:2012  
IEC 60512-9-3:2011



IDC Contacts: IDC makes a better contact resistance and transmission.

IDC contacts: IDC layout for better crosstalk performance. For 23-26AWG cables.

### Specification:

Qualified Unscreened Class E<sub>A</sub>/Cat.6A Permanent Link & Channel  
TIA-568.2-D  
IEC 60603-7-41  
ISO/IEC 11801 2.2 Edition  
CENELEC EN 50173-1

### Power over Ethernet:

PoE+ type I & II  
IEEE 802.3at  
IEC 60512-99-001 (2012-08)  
IEC 60512-9-3 (2011-06)

### Electrical:

Insulation Resistance: 500 Mohms minimum  
Contact Resistance: 20 mohms maximum

### Mechanical:

Plug insertion life: 750 Cycles minimum  
Plug retention force: 20 lbs minimum  
Temperature: -40°F to 150°F (-40°C to 68°C)

### Physicals:

Contact wires: Phosphor Bronze gold over nickel plating  
(IDC) Accept #23~26 AWG solid wire

